

FROZEN

CALLING KEY

ABBREVIATIONS

LX	Light Cue
SQ	Sound Cue
PLASTIC	Crew rustles plastic from backstage locations
NOOSE	Noose lowered in from catwalk

PLACEMENT WITHIN SCRIPT

A cue drawn to a line of text with a box placed around a single word or syllable means the GO is called on that word

A cue drawn to a line of text with an X at the beginning or end of the line means the GO is called immediately before or after that line

A cue drawn to a line of text with no markings, but with a visual note beneath the line next to the cue label means the GO is called on that specific action, which happens during that line of the play

Cues which are bracketed together should be called simultaneously with a single GO

Descriptions of cue action or sound effect are provided within cue box whenever possible

FROZEN

Blocking Key

En	Enter	π	Table
Ex	Exit	h	Chair
x	Cross	□	Desk
→	To/Toward	▢	Bench
↘	Cross Below/In front of	⋈	Stool
↗	Cross Above/behind	I	Lectern
↑	Rise	▣	Cell
↓	Sit down	◻	Door
↑	Sit up	⊕	Window
↓	Kneel	└	Tray
↑	Pick Up		
↓	Put Down	A	Agnetha
↻	Turn	N	Nancy
G→	Give	R	Ralph
←T	Take	G-1	Guard 1
↗	Lean	G-2	Guard 2
└	Stop		
↳	Look		
↯	Jump		
↗	Go up stairs		
↘	Go down stairs		
°	On top of		
°	Underneath		
°/°	Between		
P/o	Put On		
T/o	Take Off		

S/B
LX 28-29.5
SQ 44-50

RALPH. sorry.
economy sausages
fish fingers
frozen peas
AGNETHA. and
Normal is fourteen, give or take ...
Anyone who does less than nine ...
is abnormal.
And falls within mine and David Nabkus' study.⁷

¹⁰We believe Ralph is abnormal
and we believe we can show you
the reason why ...

for what it's worth₁₁

LX 28	BANG	hey David?
SQ 44		15

FIFTEEN — ABSOLUTELY NOTHING

Sound of machinery ...

NANCY. ¹⁸workman plaid shirt
came and knocked
said
"Mrs. Shirley ... we're going to have it down for you
that shed
do you want to come and watch?"
I said
"I do"

SQ 45 ²⁴We walked
it's no distance
and ...
(Nearer machinery ... engines ...)
big mechanical digger ...
... big heavy ball ... he climbs in

- 1
- 2
- 3
- 4
- 5
- 6
- 7
- 8
- 9
- 10
- 11
- 12
- 13
- 14
- 15
- 16
- 17
- 18
- 19
- 20
- 21
- 22
- 23
- 24
- 25
- 26
- 27

R - talking, - turning

Ax -> DR

Ax DR

G1 + G2 back to h

N 12

N x UR

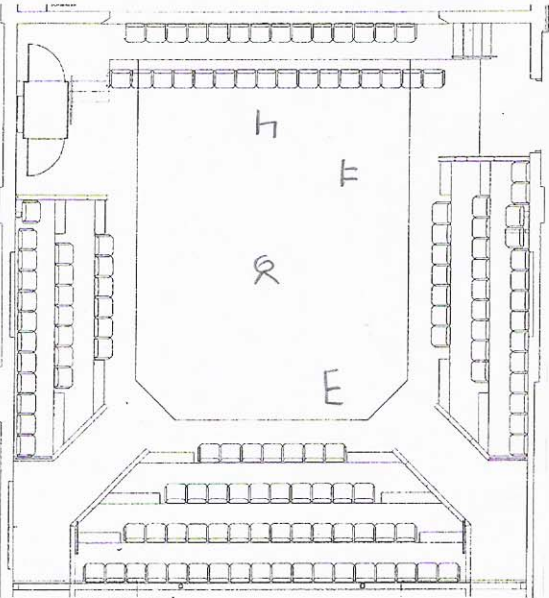

IN CUE _____
Page _____
Date _____

he says "where shall I start?"
I said
4 "that front bit where it happened"
and he hit it with the first swing
(A heavy crunch, metal against stone ...)
and the corner of the shed caved in
and he went swinging at it again and again
and
within minutes
8 it was gone
it was like my heart torn out of my chest
and oh
there was nothing there any more
11 nothing at all
just nothingness 12

SQ 46

LX 28.5

MUSIC

SQ 47

(A sound of splintering ice floes ...)

oh
help
help
help

Rhona!

LX 29

BANG

Ingrid!

SQ 48

19-23

SIXTEEN — THE BRAINS OF IT

LX 29.5

BANG - SHIFT COMPLETE - N SITS

SQ 49

AGNETHA. At this stage,
Dr Nabkus, who is the neurologist in our
partnership,

(Slight pause.)

takes a detailed medical history.
In his absence

(Slight pause.)

SQ 50

HALL OUT

25 ... I will endeavour to find out
what he would find out 26, 27

(She sits, Ralph circles round her. She watches him for a time.)

You have a little limp there, Ralph ...

- 1
- 2
- 3
- 4
- 5
- 6
- 7
- 8
- 9
- 10
- 11
- 12
- 13
- 14
- 15
- 16
- 17
- 18
- 19
- 20
- 21
- 22
- 23
- 24
- 25
- 26
- 27

N L → π

N Swing arm

N L → R and back

N x H

N \downarrow face π

G1 x π , change angle then x VR

G2 x DR

R x to SR of π

N x π , \downarrow face SL

A IS in DR \leftarrow

A x R

A \downarrow face VS

R x \nearrow to SL

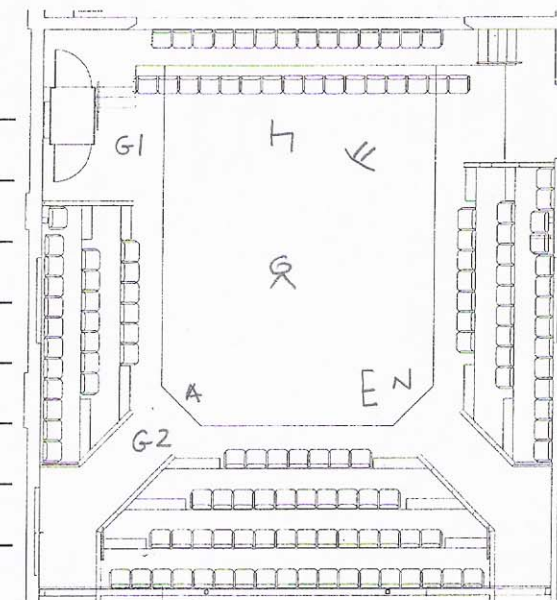

IN CUE _____

Page _____

Date _____